

7002 Series



APPLICATIONS

Shock and Vibration Isolation of aerospace, marine and mobile applications in military and civil roles.

DESCRIPTION

The mounting consists of stainless steel springs and resilient knitted stainless steel pads. The housing and base are made from anodised aluminium alloy. Securing is through tin plated brass eyelets. Weight approximately 125 grams.

DYNAMIC CHARACTERISTICS

Ratio between transverse and axial stiffness (vertical)
= approximately 1 to 2.5
Natural Frequency = 7 to 10 Hz vertical
= 4.5 to 6 Hz transverse,
depending on load, for a displacement
input +/-0.75 mm.
Transmissibility = <4:1

LOADING LIMITATIONS

Just prior to abutting the snubber, load corresponds to a continuous acceleration of at least 2g. Loads corresponding to at least 10g may be accepted without affecting the mount performance. Maximum displacement of the suspended unit under limiting loads +/-6 mm. There is no alteration in characteristics between -70°C and +175°C.

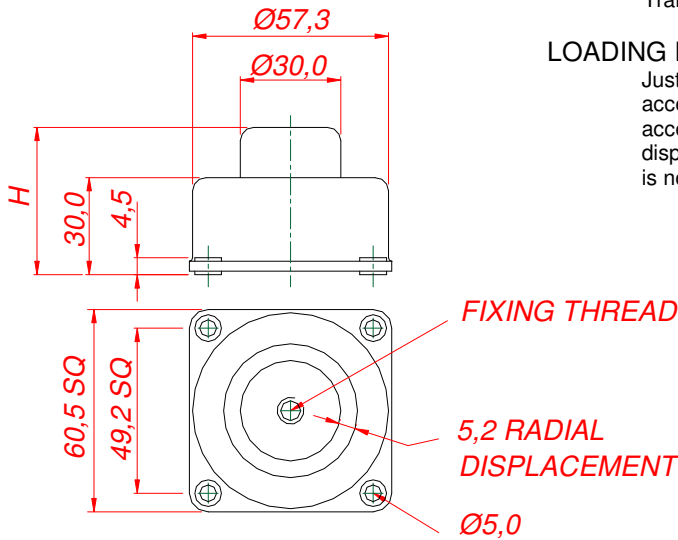

| Height, H | Short Stud | Long Stud |
|-----------|------------|-----------|
| Free | 40 | 44.6 |
| Loaded | 35 | 40 |

| Part No. | Load Range, kg |
|----------|----------------|
| 7002-1 | 0.70 - 1.25 |
| 7002-2 | 1.15 - 2.30 |
| 7002-3 | 2.00 - 4.50 |
| 7002-4 | 2.80 - 5.60 |
| 7002-5 | 4.5 - 9.0 |
| 7002-6 | 7.0 - 14.0 |
| 7002-7 | 8.0 - 18.0 |
| 7002-9 | 16.0 - 22.0 |
| 7002-10 | 20.0 - 33.0 |
| 7002-11 | 33.0 - 60.0 |
| 7002-12 | 60.0 - 110.0 |

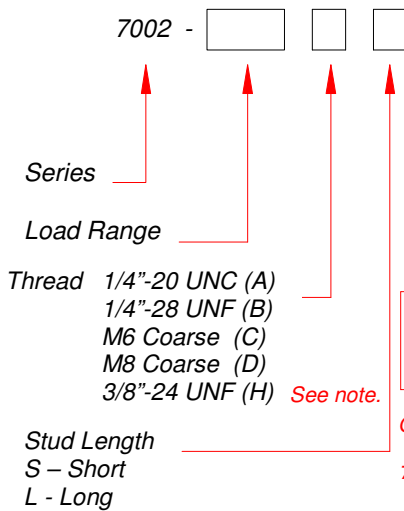

Note: 3/8"-24 UNF is available as 7002-11 HL and 7002-12HL only

Ordering example:
7002-7CS Load range 8.00 - 18.00 kg
Thread type 'C' i.e. M6
Stud length 'S' i.e. short

Typical Transmissibility Performance Curve as a function of applied load

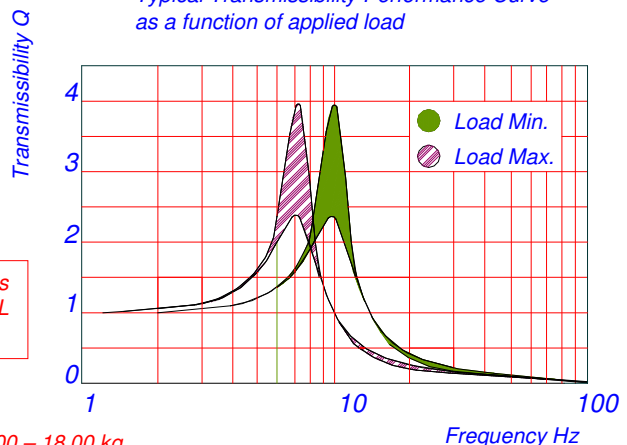

CAPARO
DYNAMICS

VIBRATION SHOCK AND NOISE CONTROL



A Division of
CAPARO
ENGINEERING
Limited

