

W1133 & W1139 Series

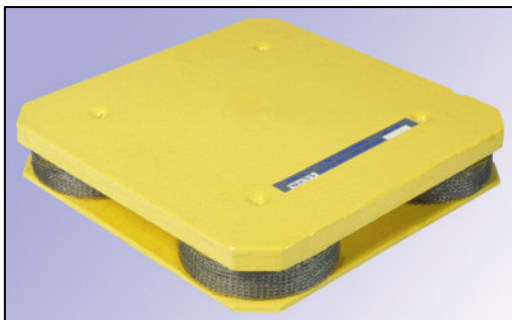

APPLICATIONS

Low profile mountings designed principally for large industrial machinery. Applications include punch presses, panel presses, large machine tools, guillotines, rock crushers etc. The W1133 is suitable where a free standing solution is applicable. The W1139 fixes the machine to the floor and is useful where changes in the centre of gravity cause the machine to move.

DESCRIPTION

Each version is essentially the same, consisting of mild steel plates with resilient stainless steel knitted mesh pads. The W1139 also includes a mild steel washer and resilient stainless steel knitted mesh pad as part of the assembly. The mild steel parts are powder coated. The W1133 uses five load bearing knitted mesh pad, the W1139 uses four only.

FLOOR FIXING

W1133 To support heavy loads the mountings are grouped on a spreader plate. The spreader plate should be made the same size of the floor bearing area of the base. The mounts are fastened to the spreader plate by the 5/8" tapped hole provided, then the spreader to the machine base.

W1139 It is important that the stud is firmly fixed into the floor before the machine is bolted down. Foundation fixings are not provided with the mounting. Use fixing studs 24 mm/ 1" maximum diameter.

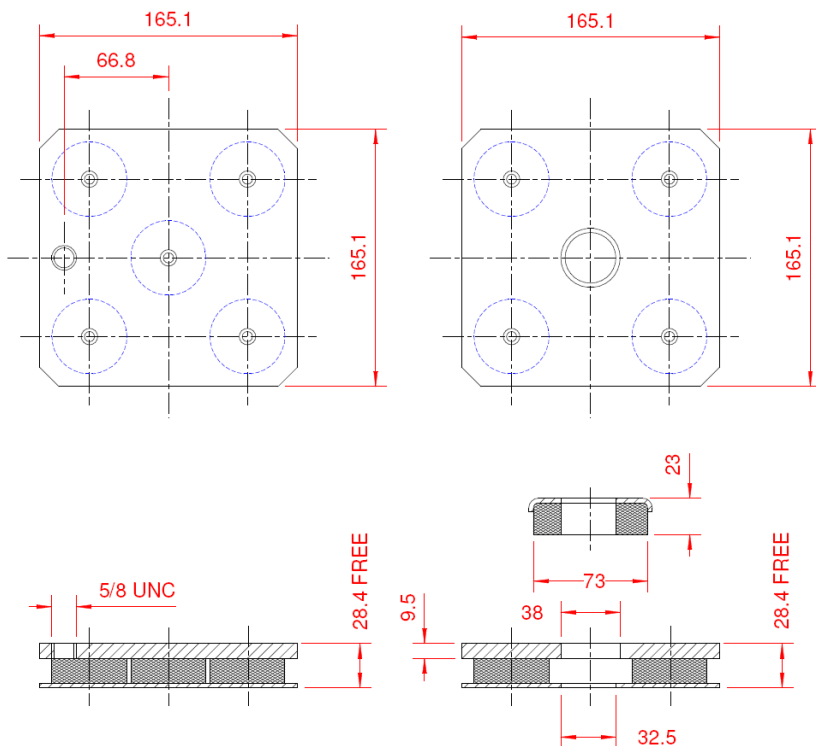

Part No.	Static Load, kg
W1133-1	453 - 906
W1133-2	906 - 2268
W1133-3	2268 - 4536
W1133-4	4536 - 9072

Part No.	Static Load, kg
W1139-1	363 - 726
W1139-2	726 - 1814
W1139-3	1814 - 3628
W1139-4	3628 - 7256

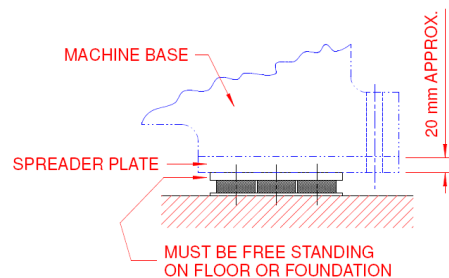

CAPARO
DYNAMICS

VIBRATION SHOCK AND NOISE CONTROL



A Division of
CAPARO
ENGINEERING
Limited

